

2 AND 4 DRUM HARDCOVER SPILL PALLET

SKU: 4062, 4064

READ ALL ASSEMBLY INSTRUCTIONS BEFORE USE

THANK YOU FOR PURCHASING YOUR ENPAC HARDCOVER AND SPILL PALLET.
 THESE EASY INSTALLATION INSTRUCTIONS WILL ASSURE YOU STABLE AND SPACE-EFFICIENT STORAGE.

SHIPPED PRODUCT CONTAINS THE FOLLOWING:

QTY	Part
(2)	SIDEWALLS (Part A)
(1)	UPPER SUPPORT BRACE (Part B)
(2)	LOWER SUPPORT LEG (Part C)
(4)	5/16" x 5.5" LONG HEX HEAD LAG SCREW (ZINC PLATED) (Part D)
(6)	5/16" x 1" FENDER WASHERS (ZINC PLATED) (Part E)
(2)	5/16"-18 x 2" CAP SCREW (STAINLESS STEEL) (Part F)
(1)	SPILL PALLET WITH TWO LOCKING HASPS (Part G)
(1)	TAMBOUR DOOR WITH RIBS ON ONE END (Part H – SHOWN BELOW)
(1)	TAMBOUR DOOR WITHOUT RIBS ON THE END (Part I)
(2)	STANDARD BLACK GRATES, (1) FOR PART #4062 ONLY (Part J)
(1)	ASSEMBLY INSTRUCTION SHEET

RECOMMENDED TOOLS:

- Cordless Drill (12v or higher)
- Hex Head to Socket Drive transition
- Ratchet with ½" Socket
- ½" Box Wrench

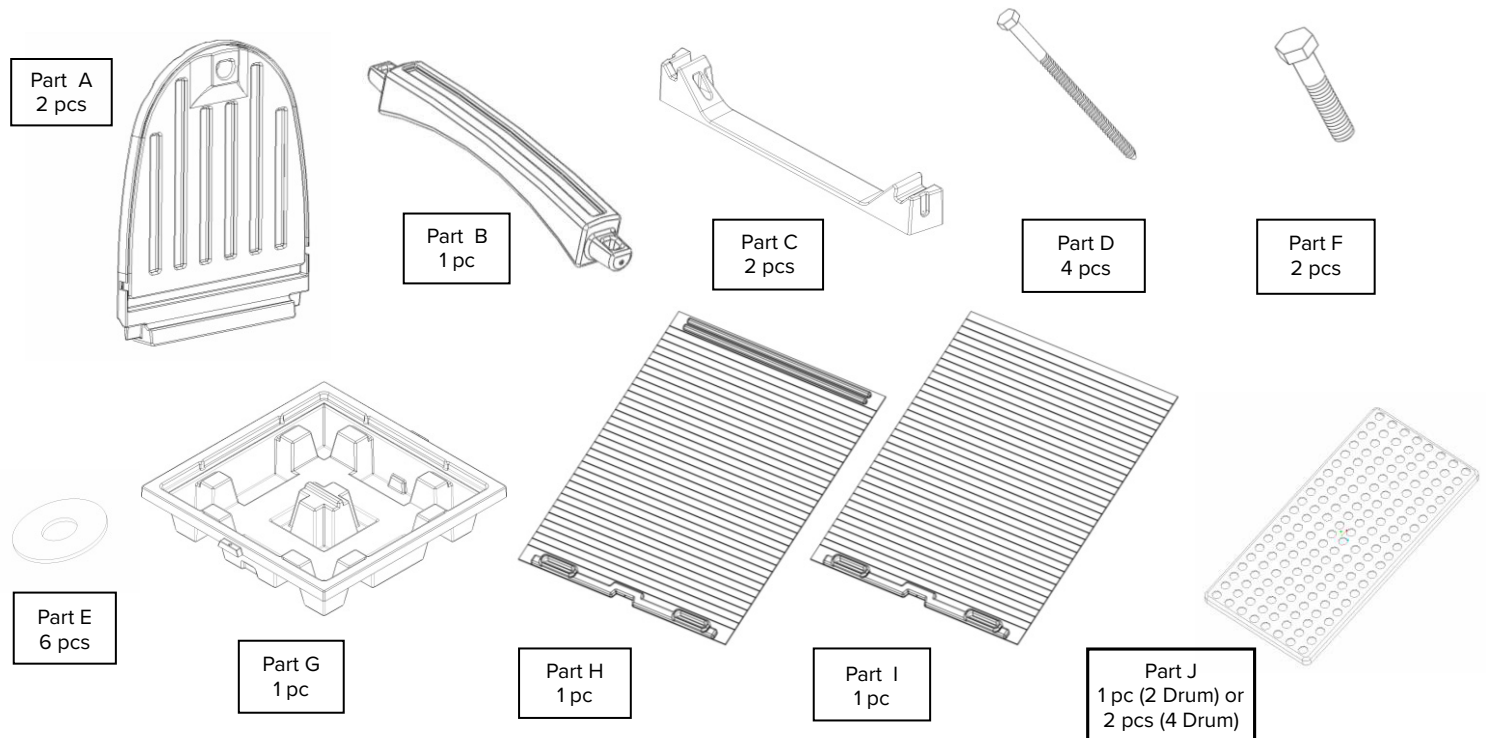

ENPAC RECOMMENDS:

- ◆ **THIS PRODUCT SHOULD BE ASSEMBLED WITH TWO PEOPLE, BUT NOT REQUIRED.**
- ◆ **UPON RECEIVING THIS PRODUCT YOU SHOULD MAKE SURE THAT ALL PARTS ARE PRESENT PER THIS INSTRUCTION SHEET BEFORE ASSEMBLING.**
- ◆ **AFTER USING YOUR SPILL PALLET HARDCOVER, YOU SHOULD COAT THE TAMBOUR DOOR TRACKS WITH SILICONE (ANY OFF THE SHELF SILICONE WILL BE FINE) FROM TIME TO TIME TO ENSURE SMOOTH SLIDING DOORS.**

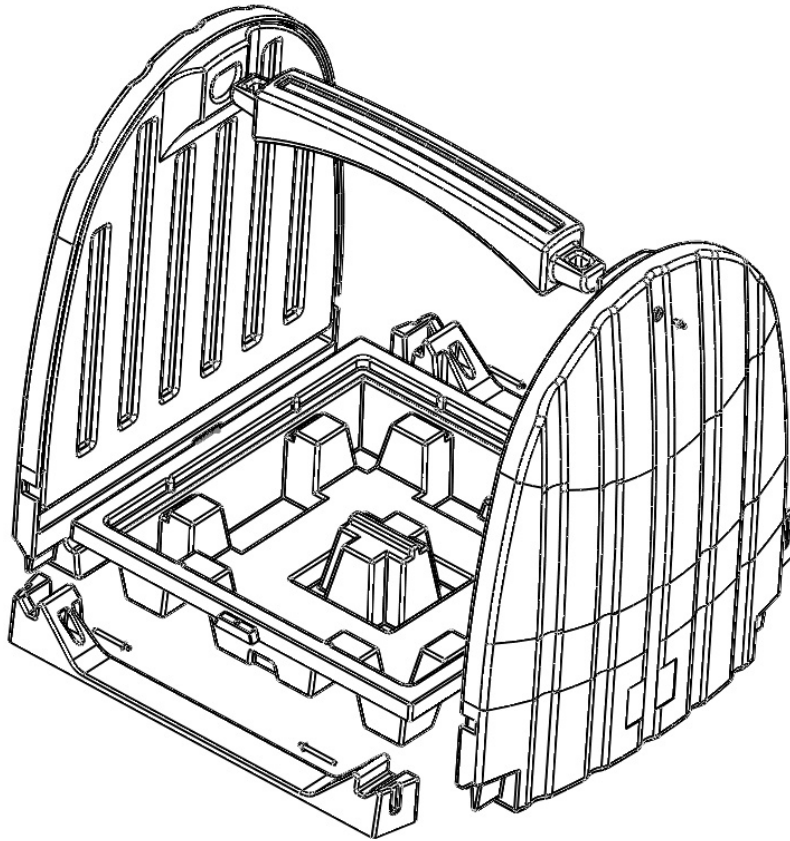
ASSEMBLY INSTRUCTIONS:

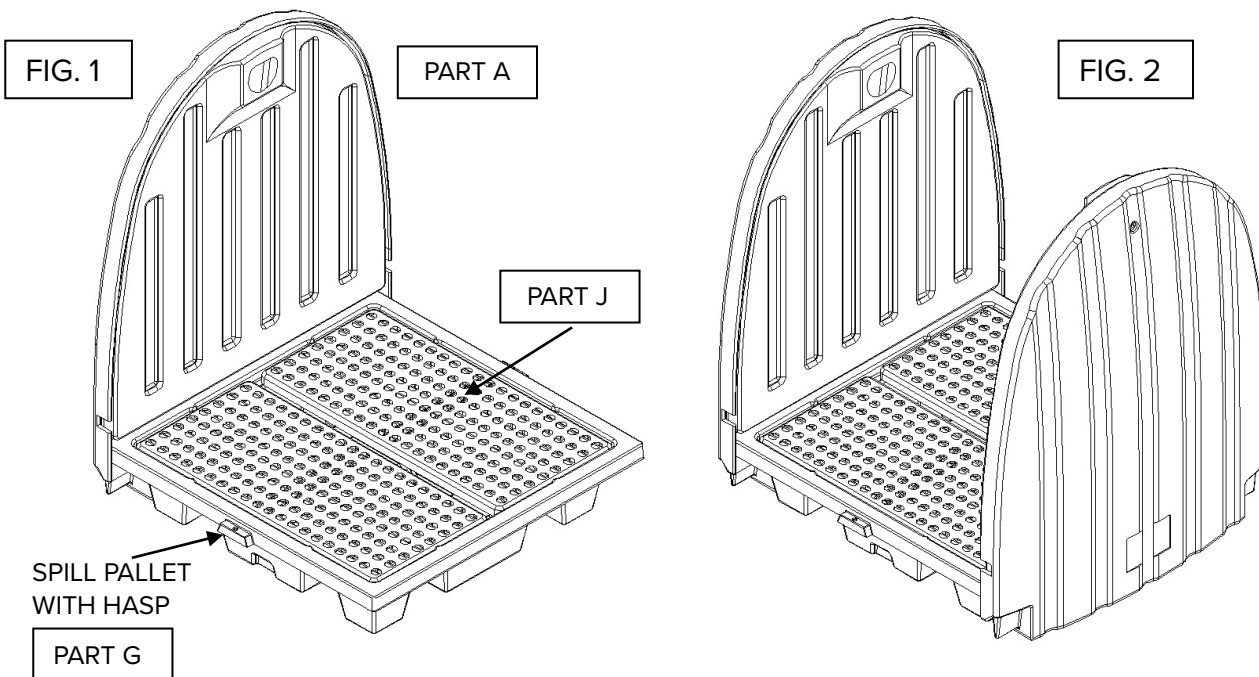

1) Stand part (A), hardcover sidewall, upwards and slide it against the edge of the spill pallet, part (G), making sure that the sides with molded in hasps are facing outward (See fig. 1). At this time place the grates, parts (J), onto the spill pallet also.



2) Place the second hardcover sidewall on the opposite side of the spill pallet. (See fig.2)

3) With the lower leg brace, part (C), placed flat on the ground in front the sidewalls, firmly press the grooved ends onto each part (A) sidewall corner (See fig. 3).

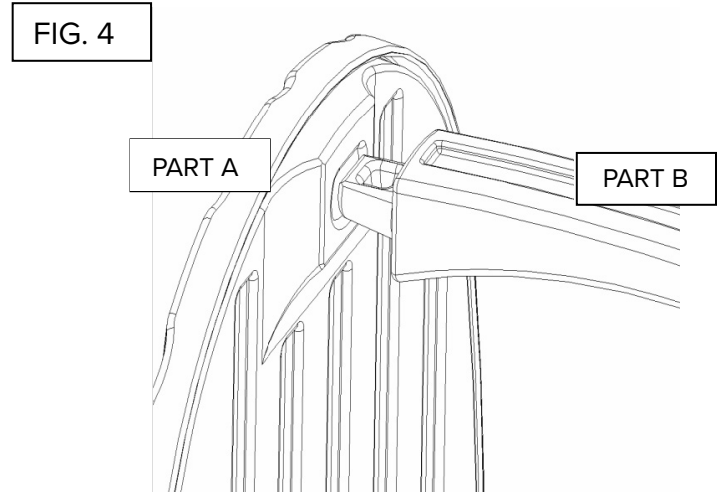
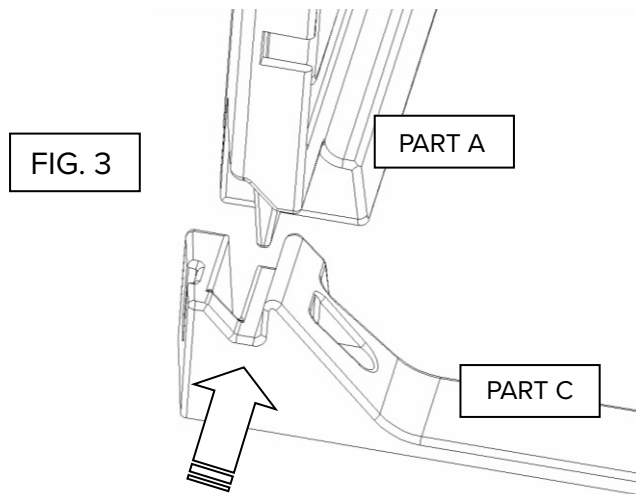

4) Repeat step 3, with remaining part (C).

5) Next insert part (B), top brace, into openings provided on part (A), sidewall. (See fig. 4)

NOTE: DO NOT USE POWER TOOLS ON THESE 2 CAP SCREWS! Start both cap screws by hand, screw in until both are almost completely in to ensure proper engagement with the insert. If the bolt does not start easily by hand, it may be necessary to tilt the sidewall towards or away from the assembler. Tighten down snug with 1/2" box wrench or ratchet and socket.

DO NOT OVER TIGHTEN SCREW.

6) Fasten part (B), top brace, with the 5/16"-18 x 2" cap screws (part F) and fender washers (part E), on each sidewall. (See fig. 6)

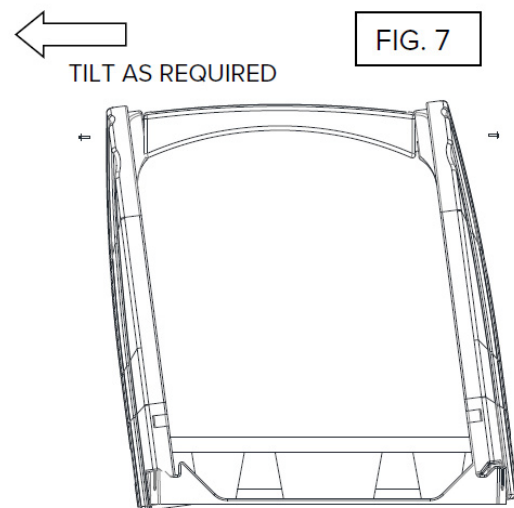
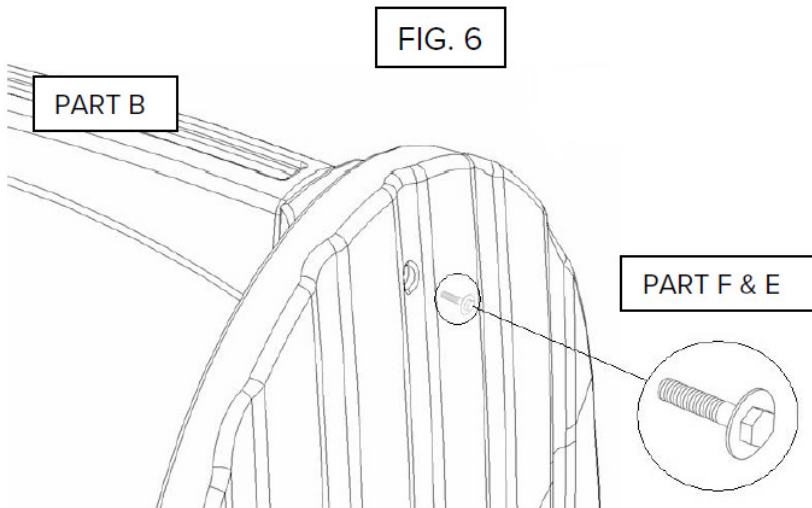

7) Drive part (D), 5/16" x 5 1/2" long lag screw with part (E) fender washer, into part (C) using the drill point located in the recess to indicate where to start the screw, tightening until it is secure at **moderate** speed so not to overheat plastic.

DO NOT OVER TIGHTEN SCREW. (See fig. 8) Repeat step 7 for the three (3) remaining corners.

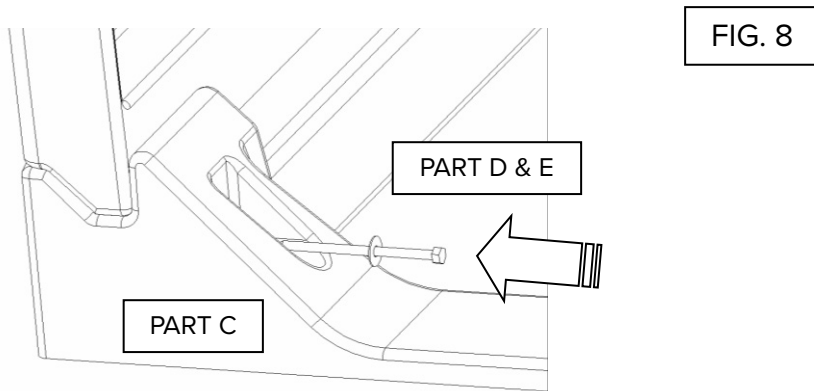

8) Place Part (I), tambour door without ribs on the end, down on the floor with the handles up, in front of the unit. (See fig. 9)

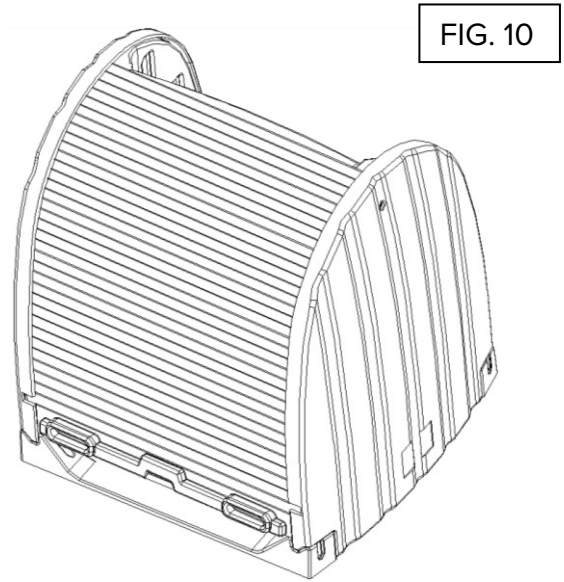
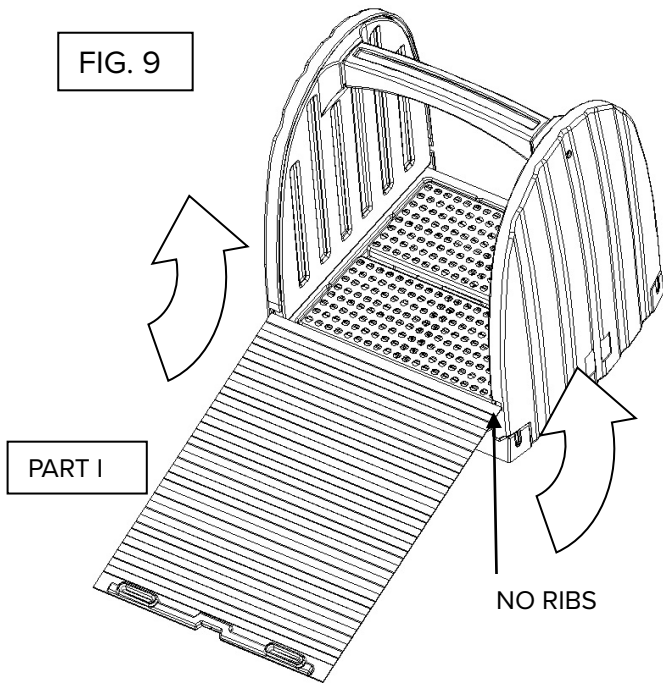

9) Ease the tambour door into the grooves provided and push the door entirely in until it is securely inserted into the sidewalls (See fig. 9 and 10). It may help to stand on the pallet and pull the door into the grooves provided and pull door towards the top of the unit. Leaving this door partially “open” may make the last step easier. (See fig. 11)

10) Repeat step 9 by installing the tambour door with the ribs and an aluminum extrusion on one end, part (H), from the opposite side of the unit, making sure part (H) is over top of part (I). (See fig. 12)

11) Complete a final operational check of the doors and lubricate if needed. If securing the unit to the ground, recesses are provided in 2 locations on each leg as shown (hardware not included). (See fig. 11)

